

# HIGH PERFORMANCE FLAMELESS SOLUTIONS



FOR PROJECTS IN WHICH YOU CANNOT USE A FLAME



Elimination of propane tools

Several possible combinations of SOPREMA products

Platinum Privilege Warranty for up to 20 years

Superior waterproofing thanks to Duo Selvedge Technology

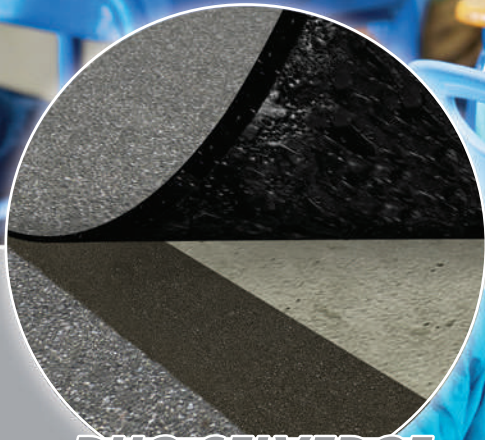

**DUO SELVEDGE**  
TECHNOLOGY



Since 1908, SOPREMA has specialized in the manufacture of waterproofing products for the construction and civil engineering fields.



1.877.MAMMOUTH  
[www.soprema.ca](http://www.soprema.ca)

SOPRALENE STICK HR GR is THE ideal solution for projects in which you cannot use a flame. Used with other SOPREMA products, this cap sheet membrane demonstrates its versatility by providing multiple configurations of systems tailored to the needs of the sites on which security is a premium issue (schools, hospitals, etc.).

## BENEFITS

- Elimination of propane tools
- Only self-adhesive cap sheet membrane to meet ASTM D6162 Type II
- Several possible combinations of SOPREMA products can be used
- Solutions adapted for projects in which using a flame is impossible
- Platinum Privilege Warranty for up to 20 years
- Superior waterproofing thanks to Duo Selvedge Technology
- Incomparable dimensional stability due to composite reinforcement
- Excellent resistance to elongation and puncture due to composite reinforcement

## DUO SELVEDGE TECHNOLOGY

For the safest installation, SOPRALENE STICK HR GR is provided with DUO SELVEDGE, a unique technology developed and patented by SOPREMA in 2004, especially adapted to this cap sheet membrane.

On the full surface of DUO SELVEDGE, 50% is sealed with self-adhesive. The remaining 50% is then safely sealed with a hot air gun. This provides an additional waterproofing safety at the laps.



**DUO SELVEDGE**  
TECHNOLOGY

SOPRALENE STICK HR GR



## CAP SHEET MEMBRANE SOPRALENE STICK HR GR

- A self-adhesive SBS modified bitumen membrane part of a flameless two-ply roofing system
- Covered with granules and self-adhesive underface protected by a silicone coated removable plastic film
- With a composite reinforcement
- A versatile membrane that can be used with all base sheet membranes shown below:

BASE SHEET  
**SOPRAFIX 640**  
(mechanically fastened)

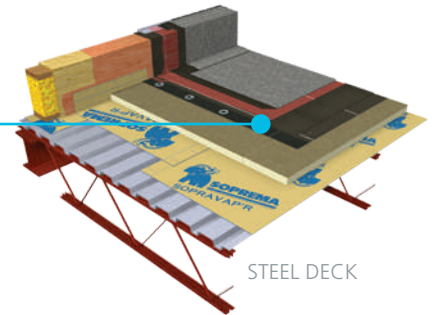

STEEL DECK

BASE SHEET  
**COLVENT 840**  
(self-adhesive)

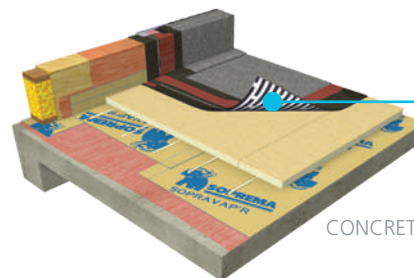

CONCRETE DECK

BASE SHEET  
**COMPOSITE PANELS**  
(e.g.: XPRESS ISO Sanded)

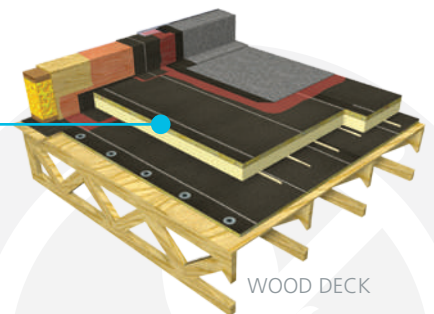

WOOD DECK

BASE SHEET  
**COLPLY 410**  
(cold applied)

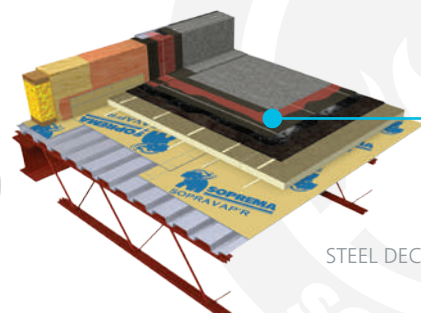

STEEL DECK

## SOPRA MATIC

The automatic hot-air welder SOPRAMATIC is the perfect tool to bond DUO SELVEDGE on the SOPREMA membranes.

- Uniform and constant fusion
- Nozzle adapted to the dimensions of DUO SELVEDGE
- Rapidity of execution
- Ideal for large surfaces

